

MARINE PRODUCT OVERVIEW

southco[®]
marine



ENGINEERED ACCESS SOLUTIONS

■ Entry and Cabin
Door Locks & Latches (Swing)



■ Electronic Access Solutions



■ Hinges & Display Mounts

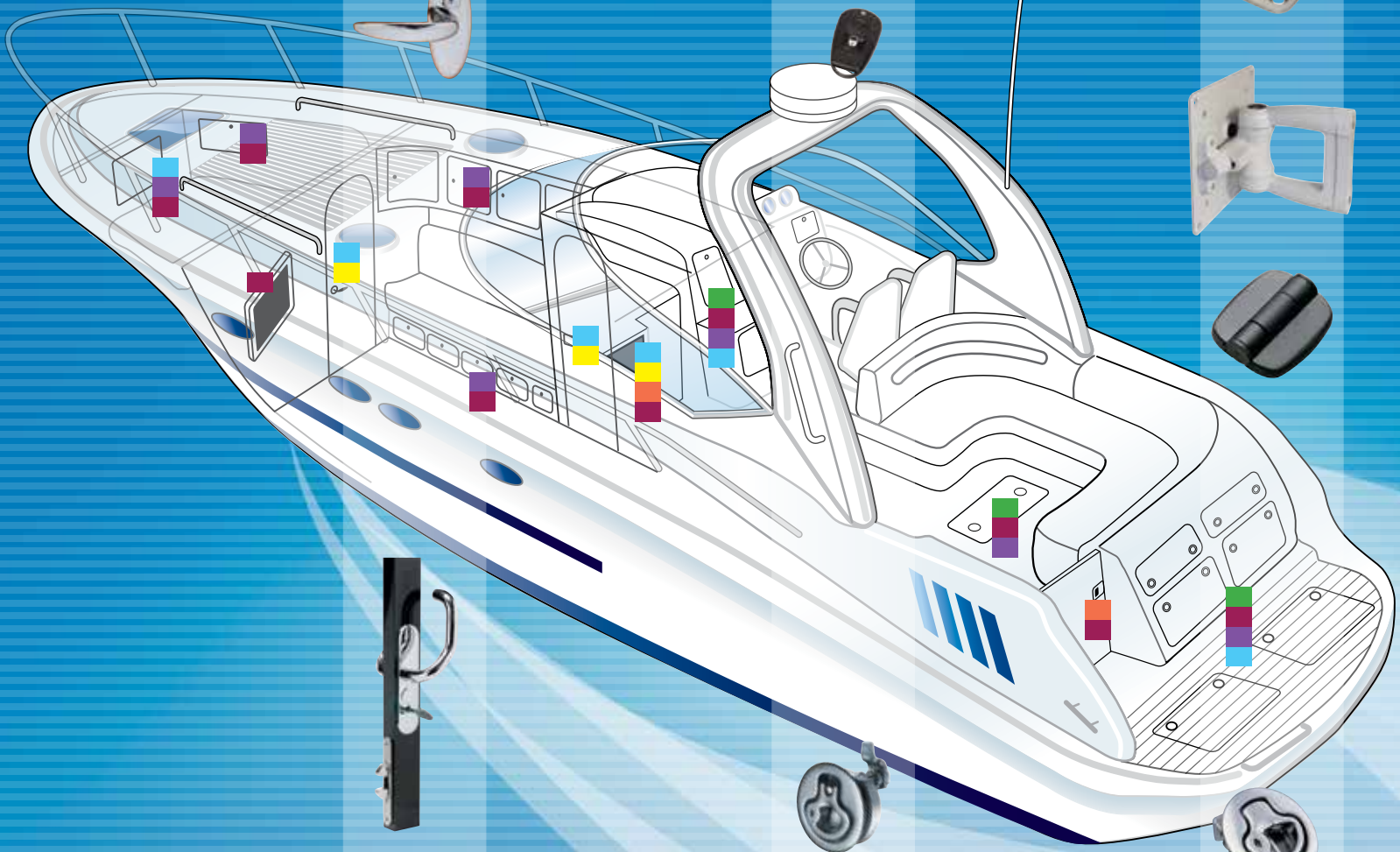

■ Entry Door Locks & Latches (Slide)



■ Compression,
Cam & Draw Latches



■ Push to Close Latches



Entry and Cabin Door Locks & Latches (Swing Doors)



Southco's entry door latching solutions feature robust construction and simple installation, and are available in a variety of styles to accommodate swinging doors.



MA McCoy

- Double-spring design provides low closing effort and keeps heavy handles in place
 - Integrated keyhole shutter protects against moisture and dust
- Door Thickness Range: 22 - 45 mm*



ME Offshore

- Flush-mount design provides a narrower profile for mounting flexibility with thinner doors
 - Versatile design works on any angle between a sliding and swing door
 - Available with left- or right-hand swing, in or out
- Door Thickness Range: 12.7 - 25.4 mm*

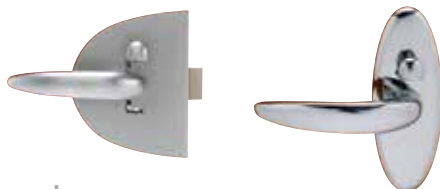

MC Compact

- Compact sizes fit lighter, thinner doors
 - Available in clamshell and mortise-mount designs
 - Ideal for cabin, stateroom and head-door use
- Door Thickness Range: 19 - 32 mm*

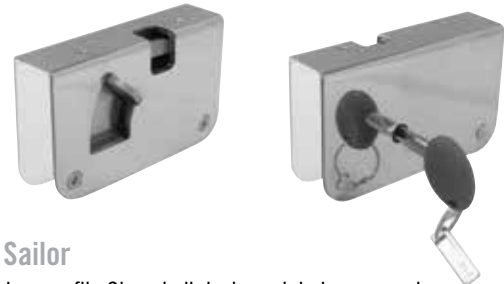

MG Star Sailor

- Clean, low-profile Clamshell design minimizes snagging
- Outside keylocking with interior privacy lock actuation
- Ideal for bi-fold doors, washboard doors, hatches and companionway drop-in panels

Door Thickness Range: 12 or 22 mm

MG L-Star

- Clean, low-profile design minimizes snagging
- Includes a three-axis six-pin tumbler design for increased security

Door Thickness Range: 19 - 45 mm without a recess, and engage with overhead hatches of 10 mm or thicker



MG Single Star

- Deadbolt can be installed alone or combined with another non-locking entry door latch
- Optional striker hood available for use on thinner hatch panels where direct attachment of a striker is difficult

Door Thickness Range: 22 - 45 mm



MR Omni & Omni Bob

- Flush, low profile design accommodates a variety of door thicknesses
- Recessed handles provide a deep grip for operating latch and opening door
- Safety feature prevents door from being accidentally locked from the inside
- Omni Bob is suitable for transom door applications

Door Thickness Range: 32 - 35 mm



Entry Door Locks & Latches (Sliding Doors)



MM Talon

- Positive-grip latch mechanisms keep doors closed under extreme conditions
- Designed for use with aluminum extrusions, wood or fiberglass doors
- Optional top stop mechanism holds door open

Door Thickness Range: 20.5 - 38 mm

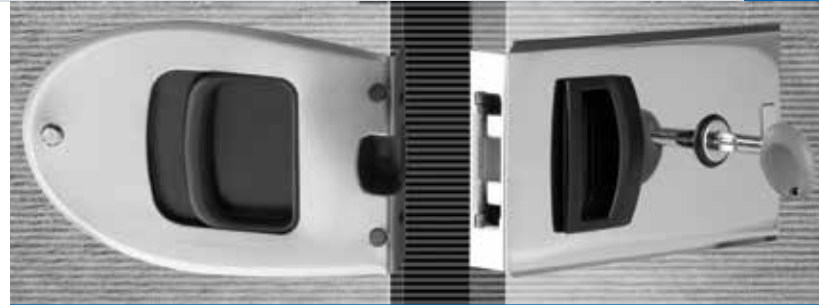

Southco's entry door latching solutions are available in a wide variety of designs to accommodate sliding door applications and feature simple installation.



MF Profush

- Flush lock design allows companionway doors to slide into recessed pockets without interfering with the helm station
- Fully sealed to provide watertight operation
- Features only 3 mm protrusion
- Adjustable for 3 mm door thickness variations

Door Thickness Range: 9 - 13 mm



MG Secure

- Easy to install – no fasteners are required
- Ideal for use on acrylic doors, bi-fold doors, hatches and companionway drop in boards
- Outside key lock with interior sliding privacy lock

Door Thickness: 12 mm or 10 mm with optional spacer

MF Flush & Omni Pocket

- Internally contained actuation handle creates a flush profile on thin panel doors
- Eliminates snags and permits doors to fit completely into recessed pockets
- Omni Pocket latch is ideal for interior pocket doors and double doors

Door Thickness: 12.7 mm or 10 mm with optional spacer (Flush)

Push-to-Close Latches



Southco's Push-to-Close latches simply slam shut, and do not require secondary steps for latching. The mechanism is mounted inside the enclosure, concealing latch points for enhanced security and aesthetics. Visible mounting styles provide actuation capability as well as a convenient handgrip for opening the door or panel.



MP Novibra - Turn to Open

- Secondary slide mechanism applies spring tension to dampen the effects of vibration
- Rear-fastening design leaves front of latch and panel free of mounting hardware
- Ideal for use with hatches, doors, drawers and cockpit lockers



93 - Push to Open

- Simple push-button actuation allows for fast, easy operation
- Low-profile model offers optional sealing cover to keep out dirt and moisture
- Knob and push-button styles available with or without locking option



MP Pull to Open

- Spring-loaded handle minimizes noise and rattle due to vibration
- Flexible mounting with adjustable striker
- Suitable for use on vertical or horizontal doors, panels and hatch covers



M1-2A - Pull to Open

- Self-adjusting pawl and flush mount keeper for flush door/frame configurations
- Flush pop-out knob for easy operation
- Single, round-hole installation



M1 Pull to Open

- Quick and easy access to frequently used areas, such as hatch covers
- Slightly angled pawl ensures tight grip on keeper, within tolerances
- Spring-loaded handles help prevent rattle





MP - Coat Hook

- Retracts to create a flush look when not in use, yet pops out easily for use
- Alignment tab permits installation in a drilled 1" round hole with 1/8" drilled keyed slot, or in a double-D hole
- Oval, square and round flange designs to compliment interiors



MP Point - Pull to Open

- Single, round hole installation
- Flush pop up knob
- Corrosion-resistant materials
- Optional latch body cover available for a more stylish look



MP - Polar

- Slim-profile magnetically actuated latch provides smooth, secure deadbolt operation
- Prevents accidental opening of sliding drawers, cabinets, or wardrobe doors due to turbulence
- Installs and operates easily in both vertical and horizontal orientations, for use with doors or drawers
- Flush installation and attractive aesthetic finishes compliment upscale interior cabin installations



C3 Grabber

- Concealed positive latch for interior and exterior doors and panels
- Pull-up operation provides tension to help prevent rattle and vibration
- Accommodate misalignment via an adjustable keeper
- Built-in microswitch option provides added functionality



MT Parrot

- Designed to mount on overhanging panels, enabling latch to be fully or partially concealed
- Latch can be easily disengaged to open panel with a single continuous motion
- Slotted striker plate mounting allows grip adjustment for positive latching
- Dampening pad eliminates the sound of the latch when closing



MT Pin Latch

- Designed for concealed latching of cabinets and compartments with overhanging lids
- Padlock eye and ring for added security
- Assembly includes latch and striker plate



8 **Push-to-Close Latches**

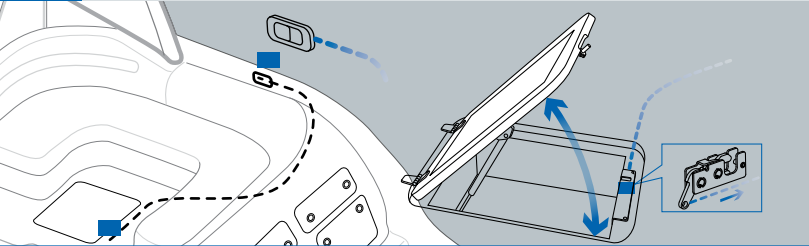

Designed for a range of interior and exterior applications, Southco's rotary latch system comprises a variety of actuators that together with cables, connect latches to actuators for concealed, remote latching. To operate the system, the end user simply triggers the actuator and the attached cable activates the rotary latch, allowing the door or panel to open.



AC Actuators

Actuators are available in a wide variety of designs, materials and finishes for interior and exterior applications.

- Key locking options
- Single point and multipoint actuation
- Suitable for mechanical override when used in conjunction with Southco's Electronic Access Solutions (EAS)



Cables and Mounting Hardware

Cables are used to connect the actuators to the latch and allow release of the latch.

- Suits "straight line" and "routed" applications
- Mounting hardware allows for flexibility in applications



R4 Rotary Latches

Southco offers a full range of robust, concealed latches.

- Stainless steel construction provides reliable performance in harsh conditions
- Two stage engagement for added protection against false latching
- Available in four sizes



Compression, Cam & Draw Latches

Compression Latches



M1 - Lift & Turn Compression Latches

- Consistent pre-set 4 mm compression
- Lift-and-turn action eliminates wear and tear on pawl and frame
- Provides a watertight seal
- Dampens vibration to reduce noise and rattle

Door Thickness Range: 4 mm - 20 mm



E3 - VISE ACTION[®] Compression Latches

- Consistent pre-set 6 mm compression
- Reduces or eliminates noise and rattle
- Over-center latching resists accidental opening due to shock or vibration

Door Thickness Range: max 18 mm

Cam Latches



E5 - CAM LATCH

- Single hole installation
- Latched and unlatched indicator
- Multiple head styles available

Door Thickness Range: 1 - 6 mm



Southco's Compression and Draw latches are available in a wide variety of styles and options to meet application needs. Draw latches provide high-strength, vibration resistant latching, while Compression latches provide noise and vibration resistance and offer a watertight seal.

Draw Latches



C7 - Flexible Draw Latches

- Soft body construction quiets vibration and prevents misalignment
- Over-center latching resists accidental opening due to shock or vibration
- Right-angle keeper design permits use in applications where panel is perpendicular to the frame
- Molded latch body conceals mechanism and mounting hardware



V7 - Draw Latches

- Fixed-grip design positions panels accurately and resists accidental opening due to stress or vibration
- Simple lever action provides secure latching with quick and easy access
- Low-profile design stands just 22.2 mm above panel
- Contoured exterior eliminates sharp edges to minimize potential for injury

Hinges & Display Mounts



Southco offers a wide range of hinges and solutions for controlling motion that can be used to enhance functionality in almost any application. Southco's line of Positioning Hinges offers standard solutions for external, concealed or fully integrated designs requiring repositioning and control of motion. Our display mounts feature zero-drift, grab-and-position operation and eliminate the need for constant readjustment and maintenance when repositioning.



E6 - Adjustable Torque Hinges

- Allows the end user to easily adjust operating effort
- Enables one product to be used across multiple, varying applications
- Available in three sizes



C6/G6 - Detent Hinges

- Holds doors open at predetermined angles
- Eliminates the cost and labour of installing additional components to maintain consistent positioning
- Secure, snap-on covers conceal mounting hardware for a clean look



AV - Display Mounts

- Precision tilt, swivel and swing out options enable effortless display positioning and infinite angle options
- Reliable, repeatable cycle life eliminates the need for service or adjustment
- VESA compliant for 12" to 23" (75 and 100 mm pattern) monitors



N6 - Hinges

- Flush-mount and two-pivot mount styles hide hinge pins from view
- Smooth installed look with no protrusions
- Stamped 304 stainless steel construction available



ST/E6 Constant Torque Hinges

- Provides constant resistance throughout the entire range of motion
- Torque preset in our manufacturing facility and never requires adjustment
- Zero-drift and backlash, even under vibration or dynamic loads



Electronic Access Solutions



Southco's Electronic Access Solutions (EAS) combine our proven electronic locks and latches with electronic actuation to provide intelligent remote controlled and monitored mechanisms. These solutions enable the transition from mechanical key locking to electronic access with intelligent electronic locking devices and a versatile line of access control systems.

Access Entry

Visible mechanical solution



Concealed mechanical solution (Stand-alone or fully integrated into a control system)



Concealed electromechanical solutions (Self contained or fully integrated into a control system)

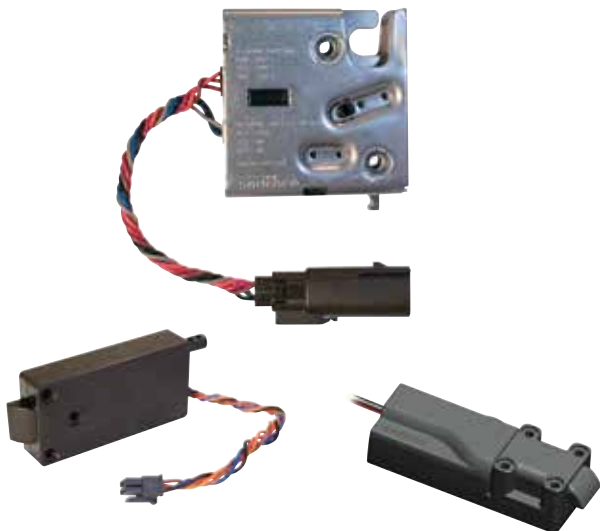

Electronic Locks and Latches

Southco offers intelligent, remotely-actuated electromechanical locking devices.

- R4-EM Electronic Rotary Latches
- Electronic Slide bolts



Access Controllers

Control any Southco electronic latch with a broad offering access controllers.

- Membrane Keypads
- Electronic Key Systems
- Wireless RF Controllers

Additional System Components

Southco offers various accessories to complete the EAS system.

- Power supplies
- Wire and cabling options
- Manual override systems

